



the dairy

WC1

12,500 sq.ft

A 12,500 sq.ft raw industrial space with some outdoor space, high ceilings, clean lines and glazed roof, flooding the space with natural light.

- 63amp 3 Phase
- Toilets
- Parking for 8 Cars
- Broadband Streaming Facility

Contact us to discuss event bookings

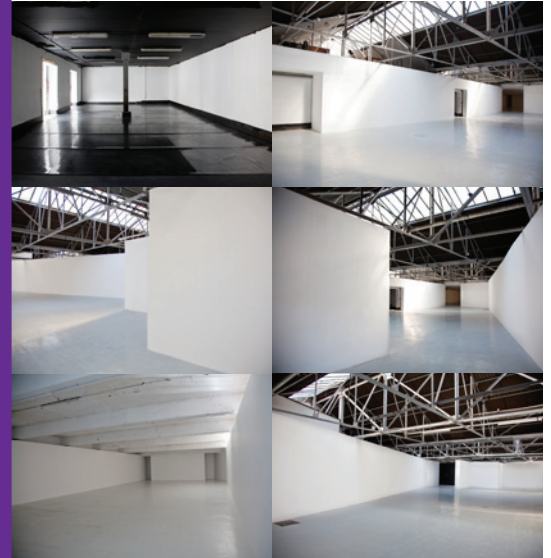

SUITABLE FOR ::

Art Exhibitions | Award Ceremonies | Car Launches | Conferences | Fashion Shows | Private & Corporate Parties |
Private Dinners | Press Shows | Product Launches | Film & Photographic Location | Set Build

**LOCATION
HOUSE**

THE DAIRY

7a Wakefield Street, London WC1N 1PG

t. +44 (0)20 7269 9750 e. info@locationhouse.co.uk w. www.locationhouse.co.uk

floor plans

THIS FLOOR PLAN IS NOT TO SCALE

ROOM A:

CEILING HEIGHT (APEX) : 7.22 m

CEILING HEIGHT (BEAMS): 3.76 m

ROOM B:

CEILING HEIGHT: 3.37 m

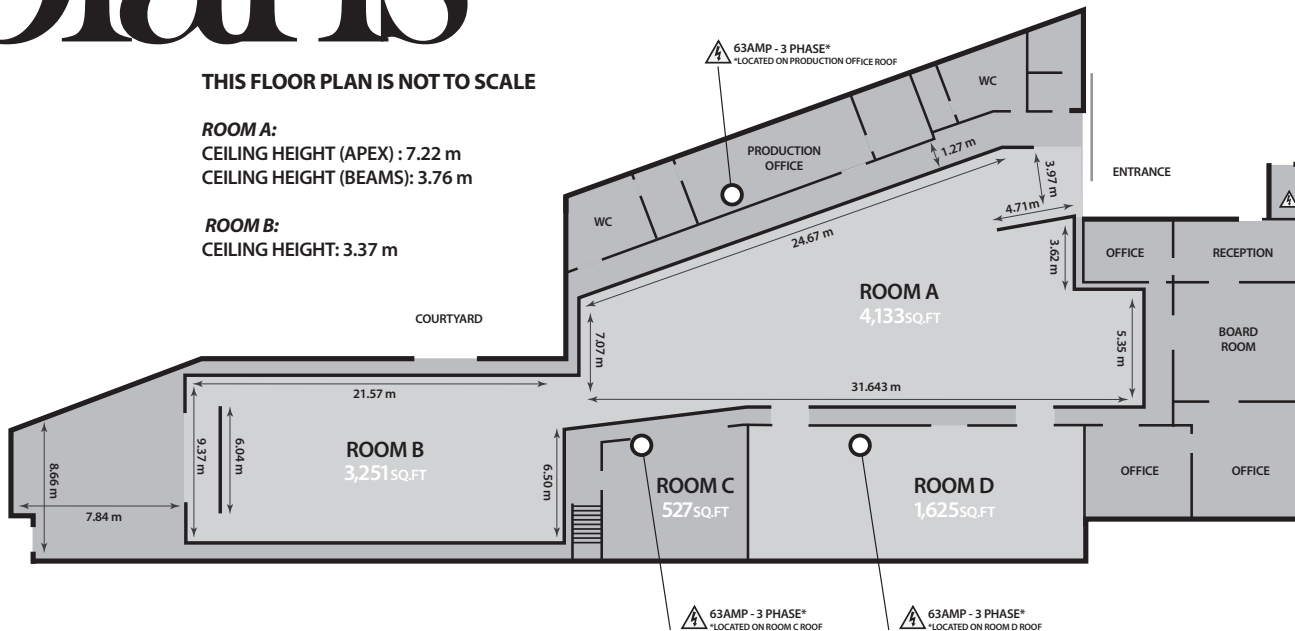

directions



transport

tube:

Holborn | Kings Cross | Russell Square

rail:

Kings Cross | St Pancras International

bus:

59, 68, 91, 168

**LOCATION
HOUSE**

THE DAIRY

7a Wakefield Street, London WC1N 1PG

t. +44 (0)20 7269 9750 e. info@locationhouse.co.uk w. www.locationhouse.co.uk

